

Slide & Chamber

* Read this instruction manual before use and keep it safe.

Cat.No.	Product Name	Sterilization	Working Volume (Max. Volume)	Culture Area per well
192-008	Slide & Chamber 8well	Sterile (EOG)	0.35mL~0.6mL (1.0mL)	70mm ²
192-004	Slide & Chamber 4well	Sterile (EOG)	0.7mL~1.4mL (2.0mL)	170mm ²
192-002	Slide & Chamber 2well	Sterile (EOG)	1.4mL~2.4mL (4.0mL)	400mm ²

* Working Volume is 35%-60% of the maximum volume.



Precautions

- The glass may break if you use excessive force when removing the hook. Be careful with the force you use to hold the glass.
- Press a cover glass gently to eject as much air as possible when you seal a sample. Excessive force may break the cover glass.
- Do not use this product for other purpose than research.
- Use gloves and a face mask when you work with this product.

Product configuration

Cover (PS)

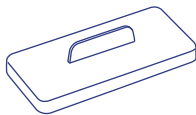

Hook (PP)

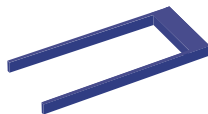

Chamber (PP)

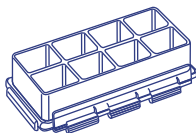

Gasket

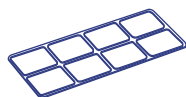

Slide glass

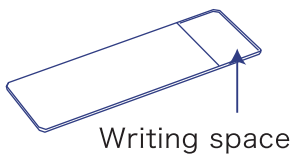

1

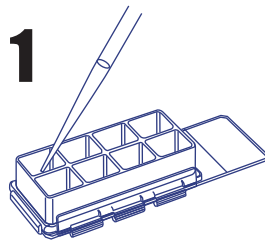

Dispense a sample into wells, place the cover on it, incubate, and immunostain.

2

Remove the hook after immunostaining.

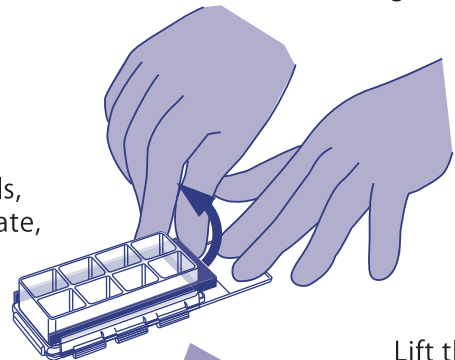

Lift the hook to remove.

3

Remove the chamber from the slide glass.

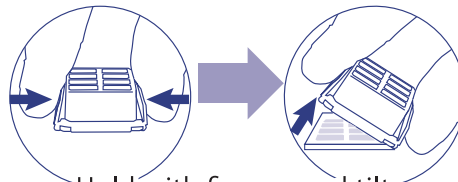

Hold with fingers and tilt.

4

Prepare separately a cover glass (24mm x 55mm) and seal the sample.

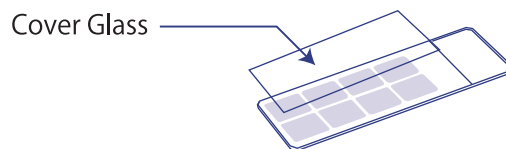

Manufactured and sold by:

FUKAEKASEI CO., LTD.

Head Office: 2-2-7 Murotani, Nishi-ku, Kobe
651-2241, JAPAN
TEL +81-78-991-4477
FAX +81-78-991-4491

E-mail: info@watson.co.jp

<https://watsonbiolab.com>

Something Different.

WATSON BIO LAB
MADE IN JAPAN SINCE 1988